

L shaped precast Retaining wall

Everything you need to know about a L shaped retaining wall in 2.5 minutes



Bob Evans

Retaining Wall Solutions



Small domestic L shape precast modular concrete walls

Retaining Wall Solutions



Bolt down retaining walls for larger load cases

Retaining Wall Solutions



Large precast L shape retaining walls using cast-in units

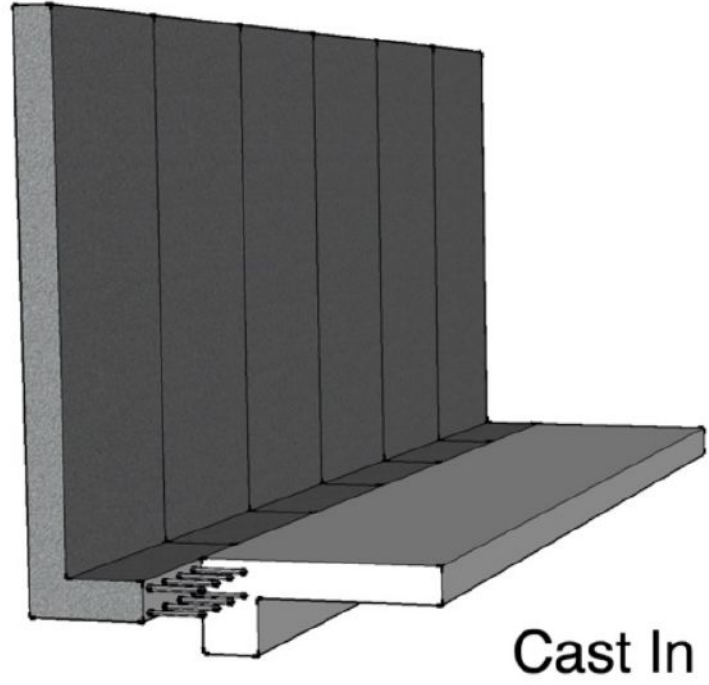
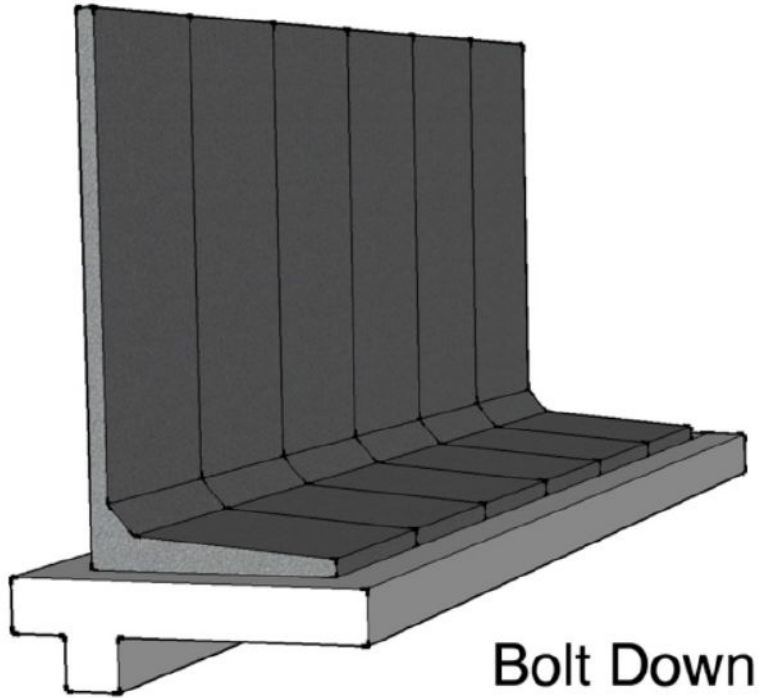

Types of L shaped units

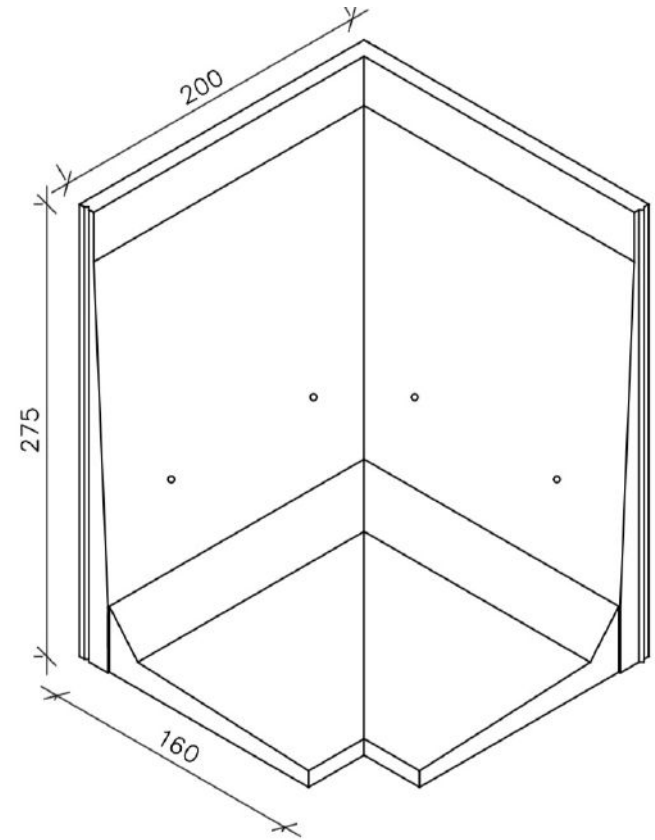

Corner units are also available

L shape design guide

Height (m)	1.2	2.0	2.4	3.0	4.0	5.0	6.0
Width (mm)	700	1000	1200	1500	2000	2500	3000
Length (mm)	1000	1000	1000	1000	1000	1000	1000
Unit weight (kg)	600	800	900	1250	2310	3290	6000
Base width (mm)	1100	1400	1600	2000	2000	3000	3500
Base depth (mm)	250	300	300	350	400	500	600
Surcharge	10kn/m ²	10kn/m ²	10kn/m ²	10kn/m ²	10kn/m ²	10kn/m ²	10kn/m ²
Factor of safety	M=1.5	M=1.5	M=1.5	M=1.5	M=1.5	M=1.5	M=1.5

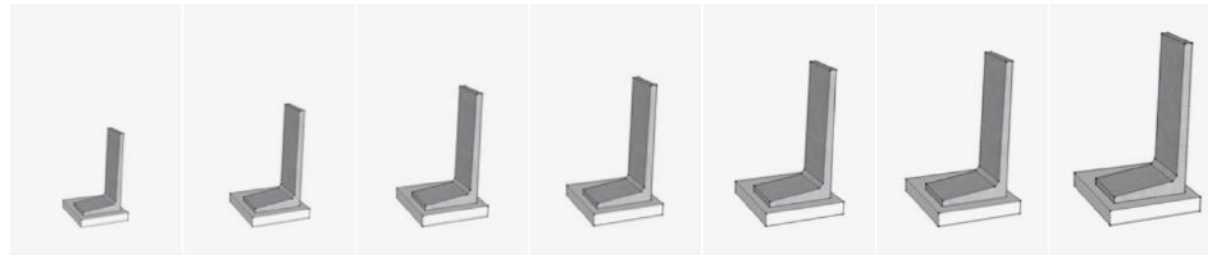

Indicative designs based upon a base material with allowable bearing pressure of **>200kPa**.

Retained material is assumed to be well graded, granular backfill with the back of wall drainage or weep holes to relieve hydrostatic pressure.

Design table to give you some examples for various wall heights

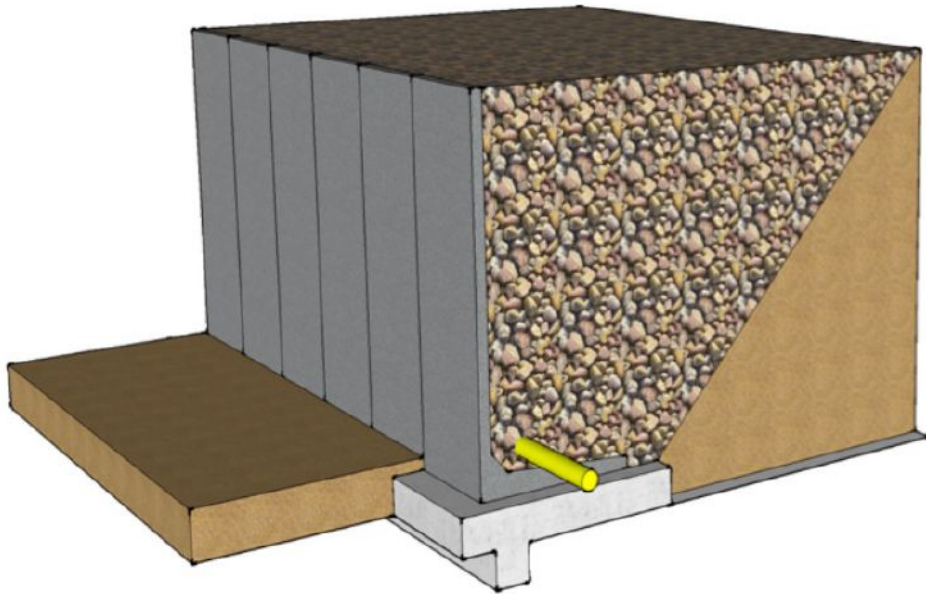

Standard

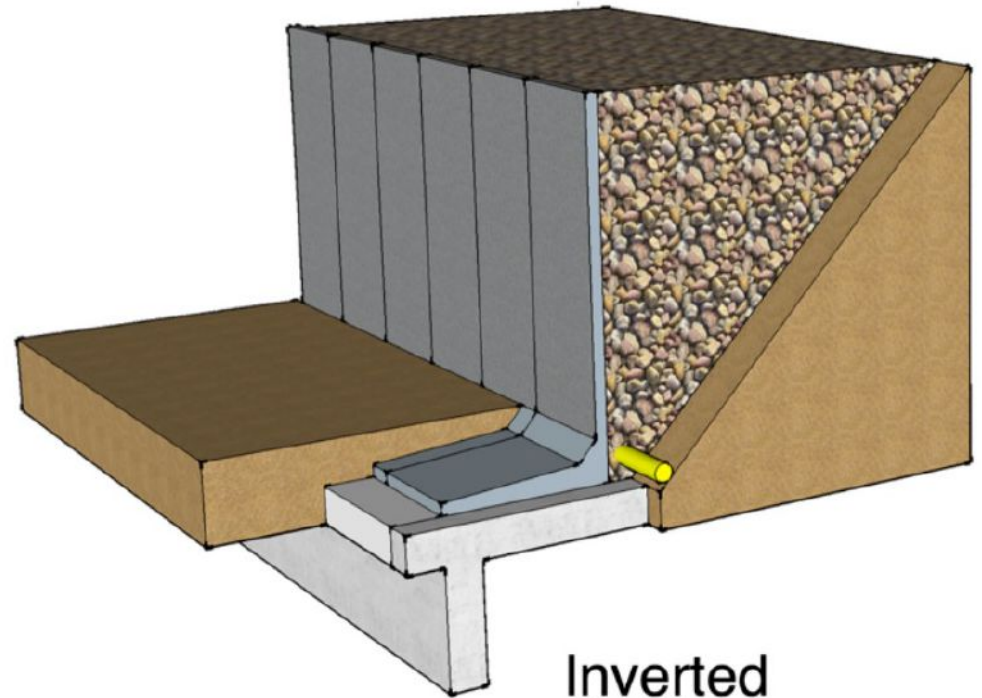

Inverted

Standard design and inverted design

Retaining Wall Solutions

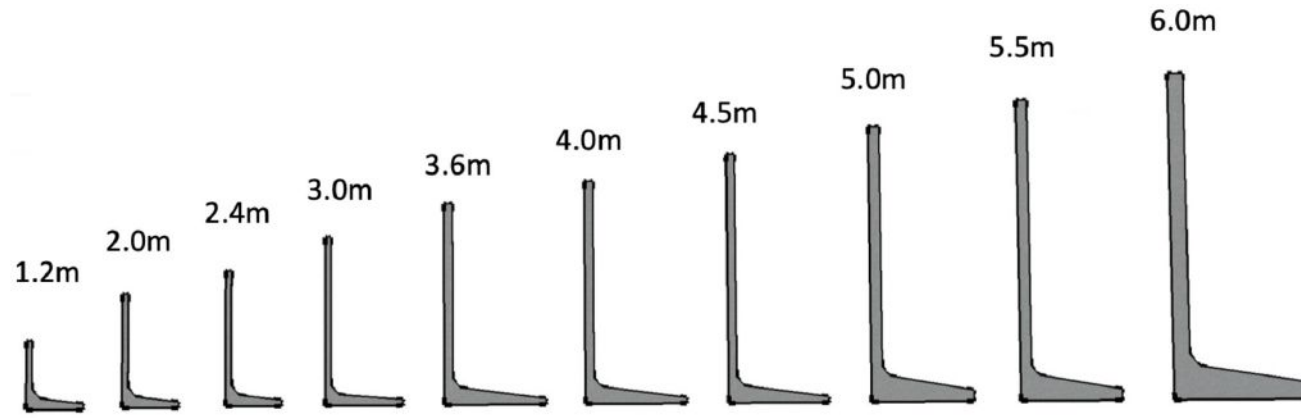

Height	Base Width	Length	Stem Thickness	Weight	Reference
1.2m	1.0m	1.0m	100mm	600kg	RWL12
2.0m	1.0m	1.0m	100mm	800kg	RWL20
2.4m	1.0m	1.0m	100mm	900kg	RWL24
3.0m	1.4m	1.0m	100mm	1250kg	RWL30
3.6m	1.85m	1.0m	150mm	2160kg	RWL35
4.0m	1.85m	1.0m	150mm	2310kg	RWL40
4.5m	1.85m	1.0m	150mm	2490kg	RWL45
5.0m	1.9m	1.0m	200mm	3290kg	RWL50
5.5m	1.9m	1.0m	200mm	33530kg	RWL55
6.0m	2.6m	1.0m	200mm	6000kg	RWL60

Standard Bolt Down Units



Retaining wall design and price guide

Which retaining wall type is the most economical to build? **Download the design guide** to learn more about each retaining wall type and get a price comparison.

Design price guide

Ask a question

How much do they cost?

Our simple 3 steps Design process

1 Step 1 - Decide on the type of retaining wall

One of the hardest things to do is to select the right retaining wall type.

Each retaining wall type has pros and cons.

Our support can help you select the right one for your requirements and budget.

2 Step 2 - Design the retaining wall

Our structural engineer is a specialist retaining wall expert. We can turn around retaining wall designs in a matter of days.

You will receive a full retaining wall report, a complete set of calculations, and a sketch showing you the design, including the material specifications.

You will also be protected by our professional indemnity insurance allowing you to sleep at night.

3 Step 3 - Use our supply chain to get the best build price

We have a comprehensive supply chain for the supply only or supply and installation of your retaining wall once it has been designed.

We can prepare material schedules and bills of quantities to give you a budget to work from.

You can save time and money trying to find suitable suppliers and contractors using our service.

L shaped precast Retaining wall

The Next Step

- Tell us about your project.
- Complete the form.
- We are here to support you.



Bob Evans